

MAKİNAMIZIN BOYU DIŞTAN İKİ KAPAK ARASI 4,3 METREDİR. DOKUNMATİK KUMANDA PANELİ VARDIR. 5 ADET ÜNİTE İÇERMEKTEDİR. PALET HIZI 9 -18 METRE / DAKİKADIR. (TRİM ÜNİTESİ AÇIKKEN 9 METRE / DAKİKA) DOKUNMATİK KUMANDA PANELİ İLE BÜTÜN ÜNİTELERİ KOLAYLIKLA KONTROL EDEBİLİR ARIZA KAYITLARINI, YAPIŞTIRDIĞINIZ PARÇA ADETİNİ, YAPIŞTIRDIĞINIZ PVC BANTIN METRESİNİ GÖREBİLİRSİNİZ.

MACHINE LENGTH 4,4 METERS FROM RIGHT TO LEFT DOOR. IT HAS TOUCHABLE SCREEN PANEL AND 5 UNITS. WORKING SPEED 9 - 18 METER/MINUTE. YOU CAN CONTROL ALL UNITS FROM TOUCHABLE SCREEN EASILY.

#### BANTMATİK 435 ÇALIŞMA ALANI / WORKING AREA

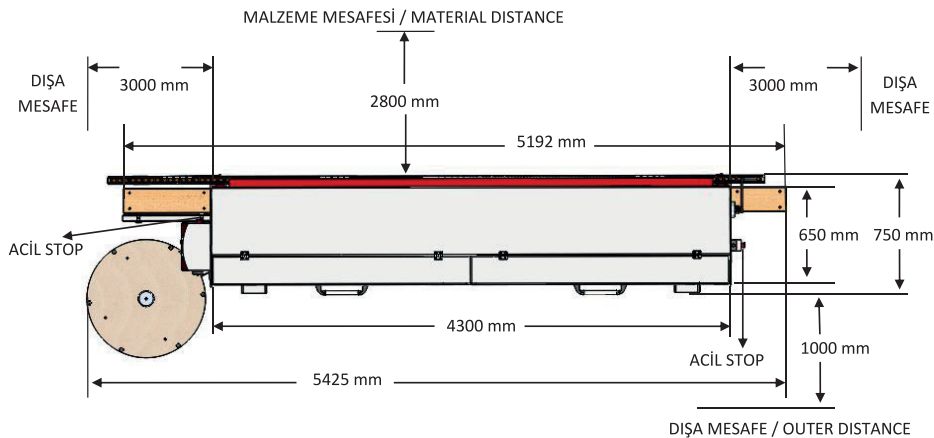

PC KONTROL ÜNİTESİ  
PC CONTROL UNIT



ÖN ISITICI SİPER  
PRE HEATER PROFILE

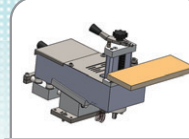

TUTKAL KAZANI  
GLUE UNIT



BASKI GRUBU  
PRESS UNIT

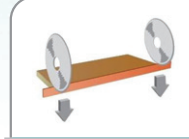

BAŞ SON KESME  
END MILLING



ALT ÜST FREZE  
BOTTOM & TOP MILLING

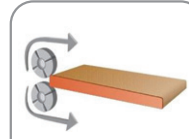

KÖŞE YUVARLAMA  
TRIMMING



R2 KAZIMA  
R2 SCRAPING



TEMİZLİK SIVISI  
CLEANING LIQUID



POLİSAJ  
BUFFER

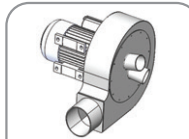

TOZ EMME ÜNİTESİ  
DUST SUCTION

#### TEKNİK ÖZELLİKLER TECHNICAL INFORMATIONS

#### BANTMATİK 435 TR-PC

<b>PANEL SIKMA KALINLIĞI</b> MAXIMUM PANEL THICKNESS	8 MM / 60 MM.
<b>BANT KALINLIĞI</b> BAND THICKNESS	0,4 MM / 5 MM.
<b>MİNİMUM PANEL BOYU</b> MINIMUM PANEL LENGTH	120 MM
<b>MİNİMUM PANEL GENİŞLİĞİ</b> MINIMUM PANEL WIDTH	100 MM
<b>TUTKAL HAZNESİ</b> GLUE CAPACITY	3 LT / 4 KG.
<b>TUTKALIN ISINMA SÜRESİ</b> GLUE HEATING TIME	20-25 DAKİKA (MINUTE)
<b>MAKİNANIN ÇALIŞMA HIZI</b> WORKING SPEED	9/18 MET/ DAK (M/MIN)
<b>BAŞ - SON KESME MOTORLARI (2 ADET)</b> END MILLING CUTTER MOTORS (2 PIECES)	0,37 KW 12.000 D/D (R.P.M)
<b>ALT-ÜST FREZE MOTORLARI (2 ADET)</b> BOTTOM-TOP MILLING CUTTER MOTORS (2 PIECES)	0,55 KW 18.000 D/D (R.P.M)
<b>TRİM FREZE MOTORLARI (2 ADET)</b> TRIM MILLING CUTTER MOTORS (2 PIECES)	0,55 KW 18.000 D/D (R.P.M)
<b>POLİSAJ MOTORLARI ( 2 ADET )</b> BUFFER MOTORS (2 PIECES)	0,25 KW / 3.000 D/D (R.P.M)
<b>TOZ EMME FAN VE MOTORU</b> DUST SUCTION MOTOR	0,75 KW 1.200 M3
<b>KURULUM GÜCÜ</b> POWER	10 KW
<b>ÇEKİLEN GERİLİM</b> VOLTAGE	380 - 400 V / 50-60 HZ
<b>ÇEKİLEN AKIM</b> CURRENT	26 AMPER
<b>ÇALIŞMA BASINCI</b> WORKING PRESSURE	4/6 BAR
<b>SEVKİYAT ÖLÇÜLERİ BOY - EN - YÜKSEKLİK</b> TRANSPORTATION DIMENSIONS LENGHT - WIDTH - HEIGHT	5.1 X 0.75 X 1.5 M
<b>TAHMİNİ AĞIRLIK</b> WEIGHT	1.700 ± 30 KG